

Impress A-Frame

Product Parts

- 1 - Frame
- 2 - Graphic (x2)

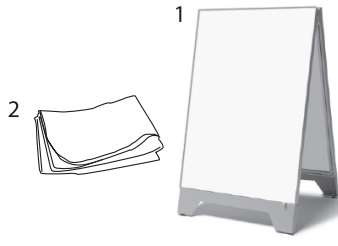

Display Set-Up

Step 1

Lay the Frame (1) on its side on a clean flat surface and install the Graphic (2) into each corner. The graphic fits into frame by inserting gasket into the extrusion channel.

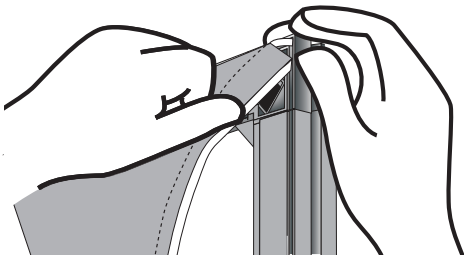

Step 2

Once each corner is secure, work towards the center on each side, using your thumbs to smooth the gasket.

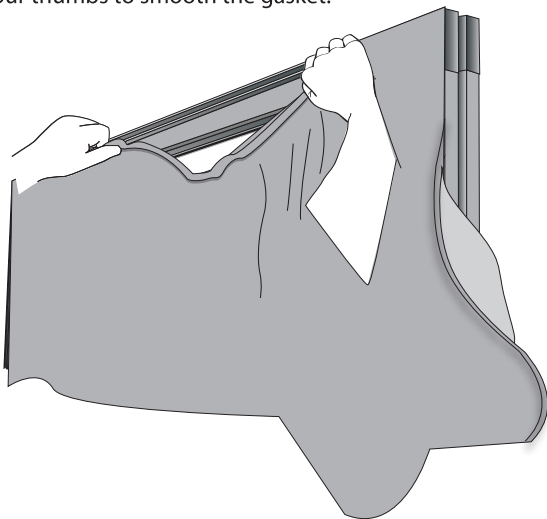

Step 3

Extend Frame (1) by pulling near bottom in opposite directions until the attached chain is taut.

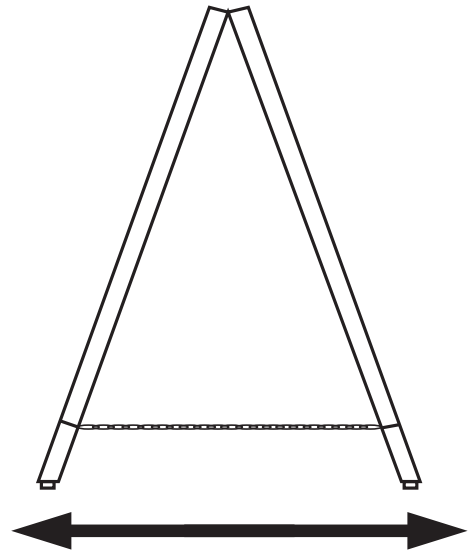

Storage & Care

DO NOT wash, DO NOT dry clean!
To clean, wipe with damp cloth.
Can be stored with graphic(s) attached.