

Crescent Fabric Display

Kit Item# 254300
Hardware Only Item # 254302
Graphic Only Item# 254301

Product	Parts
KIT	Hardware and Graphic (parts 1-8)
Hardware	Hardware only (parts 1-7)
Graphic only	Graphic Only (part 8)

Product Parts for HARDWARE

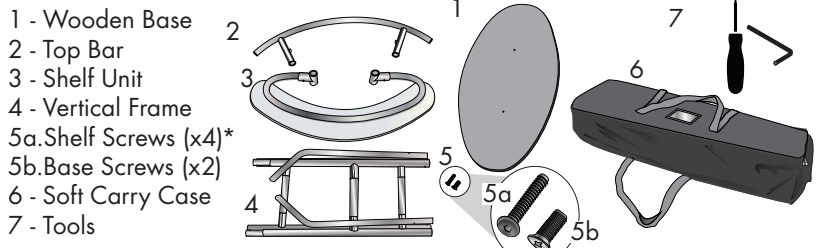

Tools Required: Allen Wrench and Phillips Screwdriver (provided)

Product Parts for FABRIC GRAPHIC (skip to STEP 5)



ALL PARTS COME IN THE KIT



Display Set-Up

Step 1

Remove all parts from the case and place on a clean flat surface.

Find the solid end of the Vertical Frame (4) that has the threaded insert, also, find the Base Screws (5b) *these are the shorter phillips screws.*

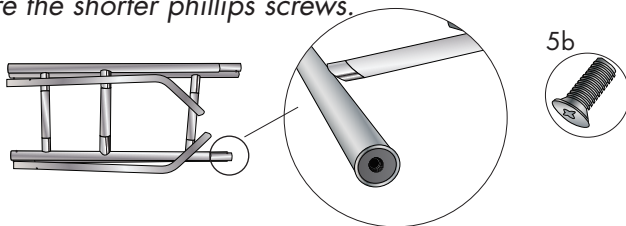

Step 2

Secure the Wooden Base (1) to the collapsed Vertical Frame (4) by threading the Base Screws (5b) through the Wooden Base (1) and into the threaded insert on the Vertical Frame (4).

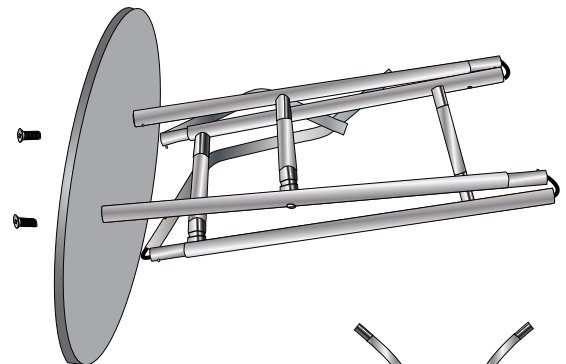

Step 3

With Wooden Base (1) secured tightly to the collapsed Vertical Frame (4) lift up the shock-corded bars and secure them together. Secure joints by placing the tapered end of one pole into the large end of the next while pressing the button snap.

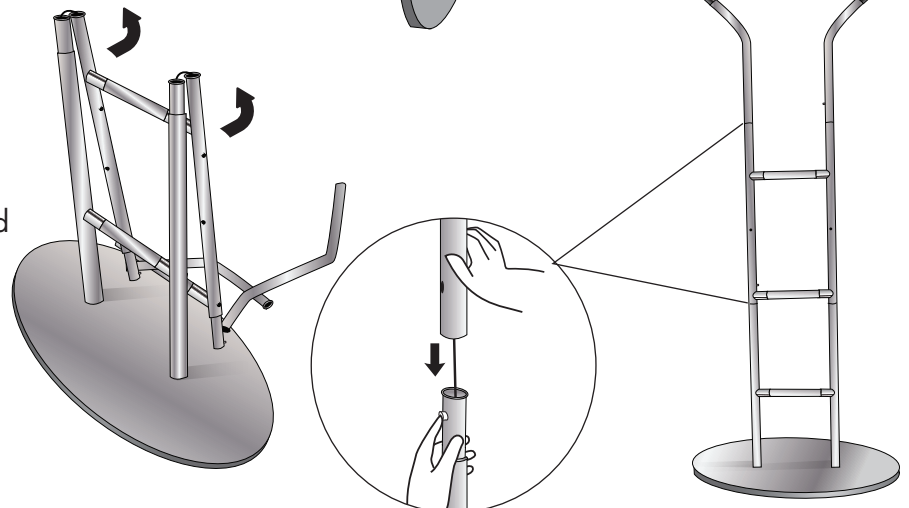

Display Set-Up Continued...

Step 4

Line up the Top Bar (2) plastic connector posts with the poles on the Vertical Frame (4). Secure into place.

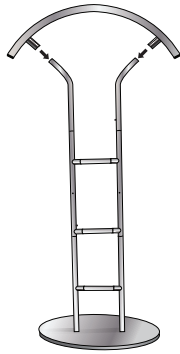

Step 6

Stand hardware unit back up. Carefully prepare the Shelf Unit (3). Remove one "T" connector from the Shelf Unit (3) *Detail View_1* and attach it to the Vertical Frame (4). Leave the other "T" connector on the Shelf Unit (3) and feed it through the opening located in the Fabric Graphic (8)

Detail View_2

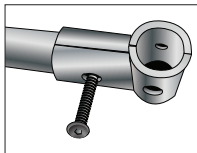
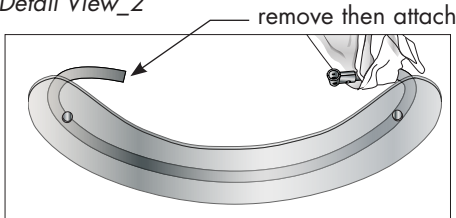

Detail View_1

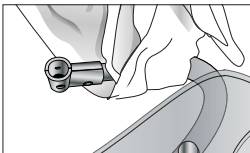

Detail View_2

Fabric Graphic (8) has a 6" finished hem opening on both sides of graphic approx. 36" up from base.

Step 8

With hex screws loosely secured, straighten the shelf unit (you may need the help of another person to hold the shelf). Hold Shelf straight and tighten all screws.

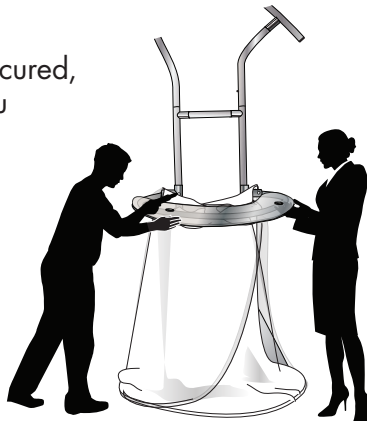

Step 5

Lay the hardware unit on its side. Slide the Fabric Graphic (8) over the Wooden Base (1) and align the bottom seam so it follows the oval shape.



Step 7

Carefully lift Shelf Unit (3) up and feed the end without the "T" connector through the other opening in the Fabric Graphic (8). Secure pole to the "T" connector that is secured to the Vertical Frame (4). You may need to loosen the screws to get pole to insert. DO NOT

secure the screw tightly at this point. Now, separate and align the other end "T" connector to the Vertical Frame. Secure to Vertical Frame and Shelf by loosely screwing together. *Detail View_3*

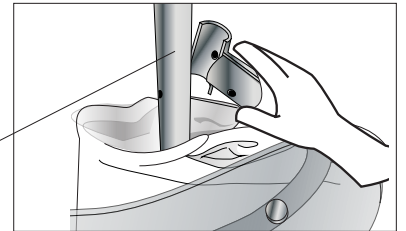
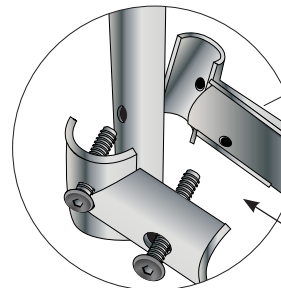
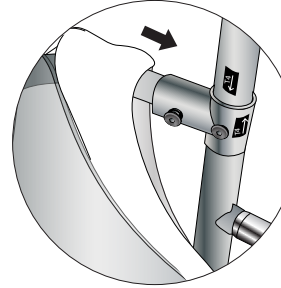

Detail View_3

Step 9

Pull Fabric Graphic (8) up and zip closed at top. You may need to lean unit back to make it easier.



Storage & Care

Reverse the steps for Disassembly and place all product parts into Soft Carry Case (6). Store in a cool dry location. **Recommended for indoor use only.**

Machine wash (cold) on gentle cycle using mild detergent. Line Dry. Do NOT dry clean, Do NOT Iron.

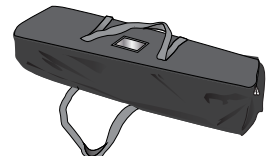

Warranty Information: All products are designed to provide the user with a cost-effective and durable product. Standard warranty is a 'one year parts and labor' warranty which warrants product against defects in material and workmanship. It does not cover damage due to accidents, abuse, or normal wear and tear. Products found to be defective will be replaced or repaired at factory's discretion.