

8' ARISE Curved Floor display Kit (Mural)

Product Parts

- 1 - 9-quad curved frame
- 2 - Magnet Bars (x18)
- 3 - Hardware Bag
- 4 - Double LED Light Kit
- 5 - Mural Center Panels (x3)
- 6 - Mural End Panels (x2)
- 7 - Mural Case-to-Counter Kit
- 8 - Oval Shipping Case w/ Wheels



Display Set-up

Step 1

Remove Frame (1) from case. Standing in front or behind, expand the Frame by pulling up from the middle.

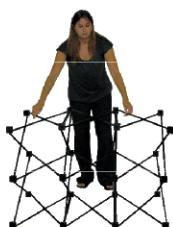

Step 2

Refer to Page 2 for instructions to install the Double LED Light Kit (4).



Step 3

Stabilize the unit by engaging the MAGNAFORCE™ locking bars into place.

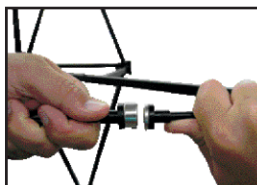

Step 4

Beginning at the bottom and working up, attach the 18 Magnet Bars (2) by aligning the cut-outs on the bars with the center of the hub on the Frame (1). They will snap into place. Apply to the front, and the two back corners.

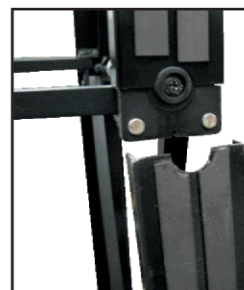

Step 5

Remove Panels (5, 6) from their protective sleeves. Do not discard the sleeves - instead keep them in the case for future storage.

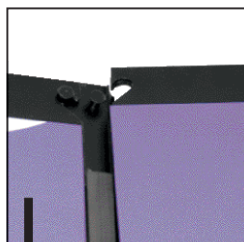

Hang the Center Panels (5) from the hanging pins at the top, then attach them to the Magnet Bars (2) by aligning the magnetic strips.

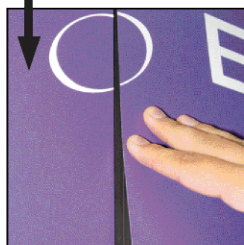

Step 6

Hang the two End Panels (6). Curl them around the corners and attach them to the Magnet Bars (2) in front and in back.

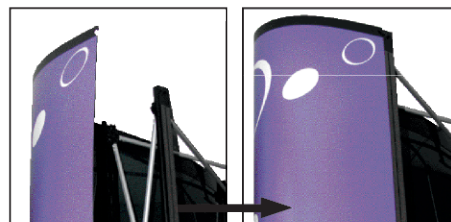

Step 7

Place the wrap part of the Case-to-Counter kit (7) around the Oval Shipping case (8) and secure it with the hook and loop strips. Place the oval counter top in the groove on the top of the Shipping Case.



ARISE Storage & Care

Place all product parts into Carry Case and store in a cool dry location. To clean non-graphic hardware, wipe with a damp cloth.

Display Disassembly

Step 1

Remove all Panels (5, 6) and carefully roll them up with the graphic side out into the clear protective sleeves.

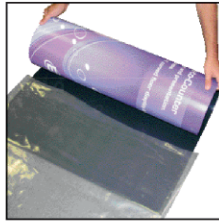

Step 2

Carefully place graphics in the Shipping Case (8), graphic side out. Roll the panels so they're along the perimeter of the case.

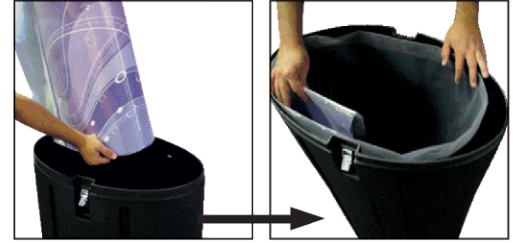

Step 3

Remove the 18 Magnetic Bars (2) from the Frame (1) and store them in the black Hardware Bag (3).



Step 4

Carefully collapse the Frame (1) by disengaging the MAGNAFORCE™ locking bars. Store the Frame in the Shipping Case (8).



Ultimate LED Double Light Kit

Product Parts

- 1 - Light Head (x2)
- 2 - Hex Wrench
- 3 - 16mm Hex Screw (x10)
- 4 - 30mm Hex Screw (x10)
- 5 - Nylon Lock Nut (x4)
- 6 - 8mm Wrench
- 7 - Quick Release Pin (x2)
- 8 - Horizontal Adapter Bracket (x2)
- 9 - Light Support Mount* (x2)
- 10 - Clamp* (x2)
- 11 - USB Adapter
- 12 - Light Adapter for ARISE frame (x2)



*The Light Support Mount (9) and Clamp (10) are not needed to equip lights to the ARISE display.

Light Set-Up

Step 1

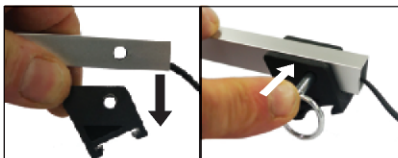

Sit the Light Head's (1) pole in the Light Adapter (12) so that the bottom holes line up, and insert the Quick Release Pin (7) through to the other side.

Step 2

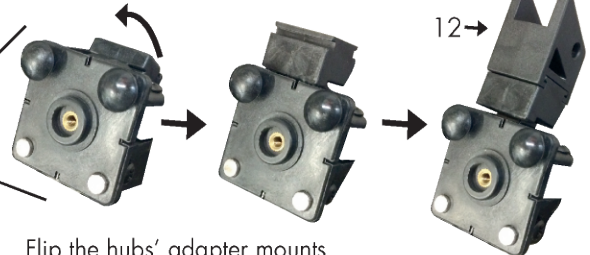
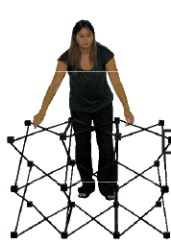

Flip the hubs' adapter mounts so they're facing upwards.

Slide adapters/lights from step 1 onto the hub mounts.

Power Options

The USB Adapter can power up to two Light Heads and allows an additional cord to be plugged into it. Please note that the light head can be powered by other USB-based power sources like laptops.



Light Kit Storage & Care

Place all product parts into carry case and store in a cool, dry location. To clean, wipe with damp cloth.