

# Mini Sail Sign - Clip

## Product Parts

- 1 - Base Pole
- 2 - Top Pole
- 3 - Graphic

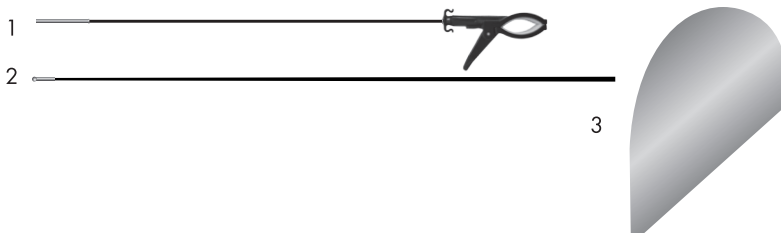

## Set-up Instructions

### Step 1

Insert the Top Base Pole (2) into the Base Pole (1).

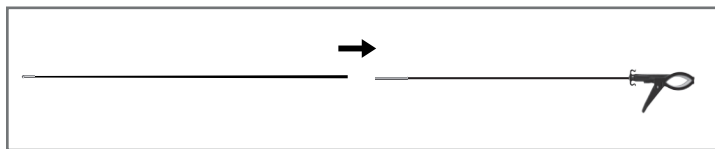

### Step 2

Slide the Graphic (3) onto the Pole Assembly

Hook the Elastic Cord to either plastic hook on the base of the Pole.

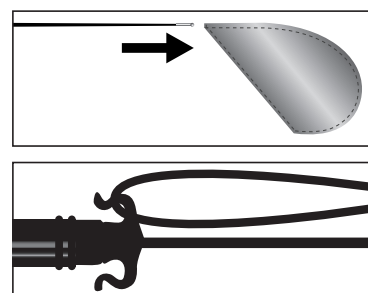

### Step 3

Clamp the product to any pole or shape less than 1.5" in diameter.

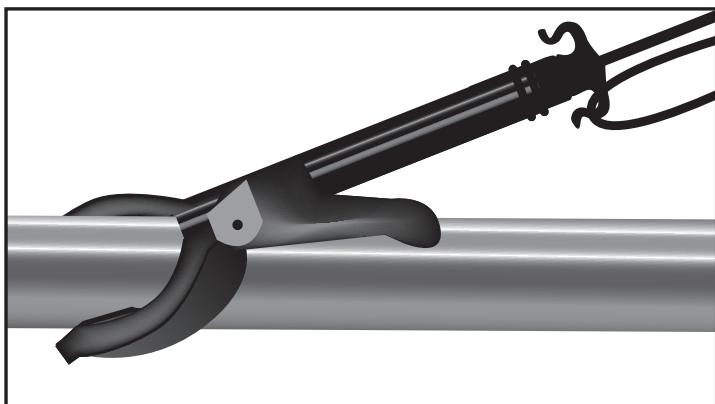

## Storage & Care

Store in a cool dry location, away from direct sunlight. To clean, machine wash on cold gentle cycle. Tumble Dry-No Heat. Steam clean for wrinkles. Do not iron or dry clean the banner.