

Half Wall Stabilizing Bar

Product Parts

- 1 - Molded Plastic Clamps (see options) qty: (see chart to right)
- 2 - Bolt Handle qty: (see chart to right)
- 3 - Long Bar qty: 2
- 4 - Short Bar qty: 1
- 5 - End Bars (Compact Kit only)
- 6 - Middle Bar (Compact Kit only)

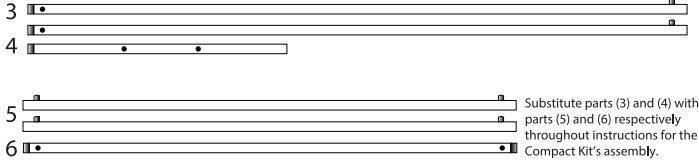
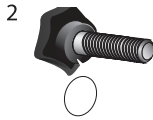

Substitute parts (3) and (4) with parts (5) and (6) respectively throughout instructions for the Compact Kit's assembly.

* Walls sold separately or as kits

Clamp Options

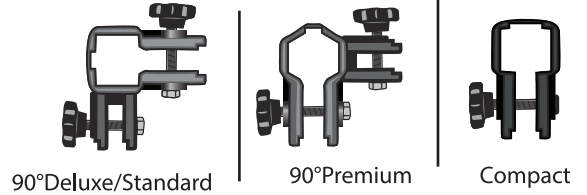
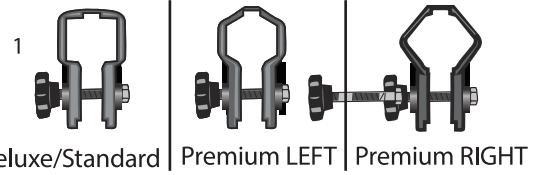

* 90° Clamps sold separately

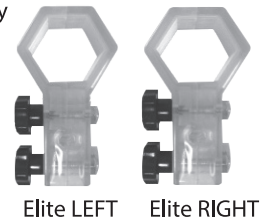

Assembly

Step 1

Insert end of Long Bar (3), while pushing down the button, into one end of the Short Bar (4). Verify that the release button clicks into place. Repeat for other end. NOTE: the button will be on the underside of your stabilizing bar.

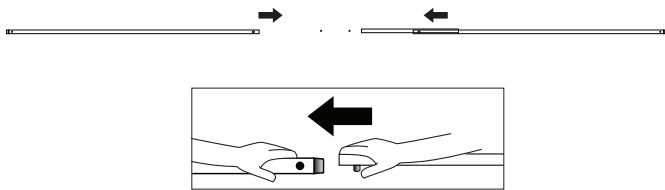

Step 2

On existing tent frame, place one of the Molded Plastic Clamps (1) around the leg. The open end of the Molded Plastic Clamp (1) should face towards the other tent leg you want the stabilizing bar to span. Clamp threaded inserts should face toward inside of tent***

Repeat for opposite tent leg. (See Step 2 note for Premium tent)

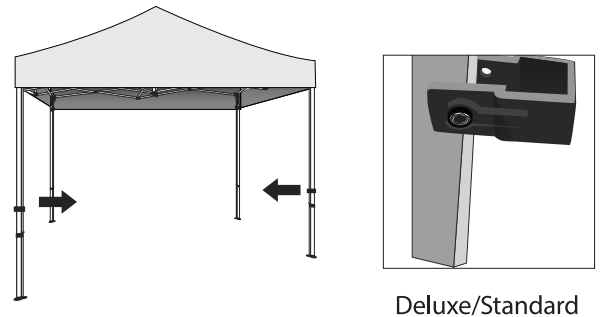

Step 2 NOTE:

Please note: The Premium and Elite tent Molded Plastic Clamps (1) are molded to ensure correct fit around the hexagon tent leg. Verify that you have the correct Clamp on the correct tent leg.

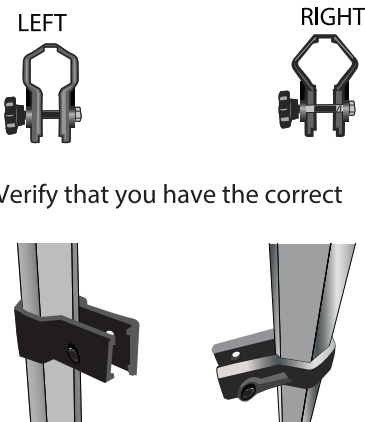

Step 3

Insert one end of the stabilizing bar (created in Step 1) into one of the Molded Plastic Clamp (1) (If you have a tent half wall make sure to install it before you insert bar into Clamp)

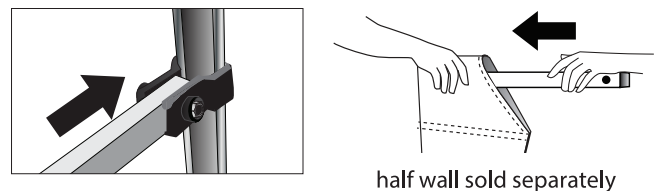

half wall sold separately

Assembly Continued

Step 4

Insert *Bolt Handle (2) through the hole on the Molded Plastic Clamp and the stabilizing bar, secure to the threaded insert on the Molded Plastic Clamp. Repeat on other leg.

* Elite Clamps have two Bolts.

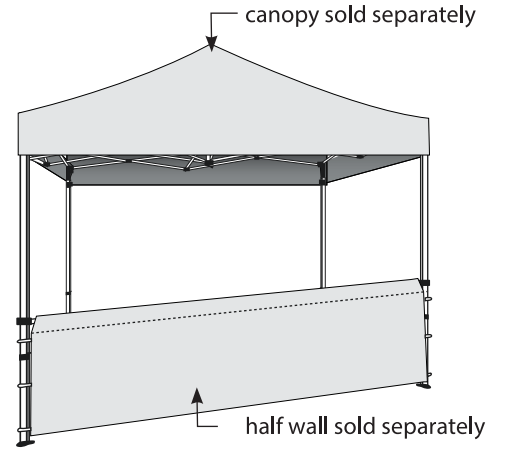
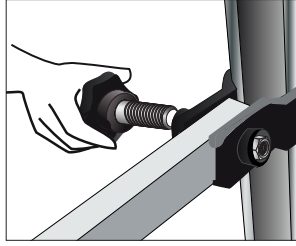

INSTALL NOTE

*** Make sure threaded insert faces toward inside of the tent.

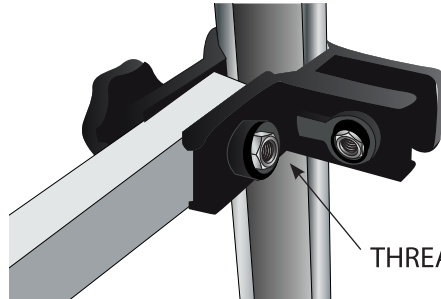

* Clamp shown is optional 90° Clamps (sold separately)

Storage and Care

Step 1

Wipe clean with a damp cloth. Store in a cool, dry place.