

Scan to view Product Instructional Video or visit:  
[www.creativeDisplaysite.com/SnapAframe.html](http://www.creativeDisplaysite.com/SnapAframe.html)

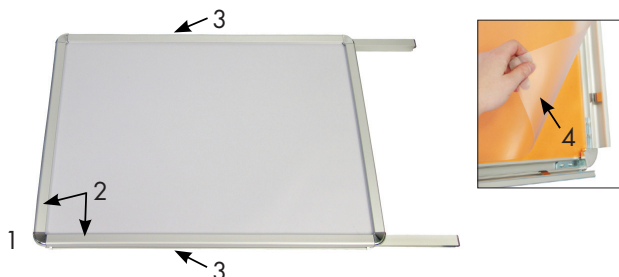

## Product Parts

- 1 - A-Frame
- 2 - Snap Edges
- 3 - Side Hinges
- 4 - Acrylic Inserts



## Graphic Install

### Step 1

Remove from box and lay on a clean flat surface. Open all four Snap Edges (2), lift the Acrylic Inserts (4), and place the Graphic in the frame with the Acrylic Inserts (4) on top. Close all four Snap Edges (2).

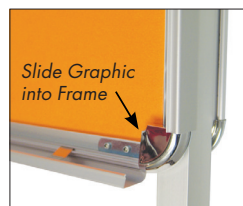

### Step 2

Turn the A-Frame (1) to on the other side and repeat Step 1 to install a second graphic.

## Display Set-Up

### Step 1

Stand A-Frame (1) upright and separate the front and back legs. Push the Side Hinges (3) down to lock the A-Frame (1) in position.

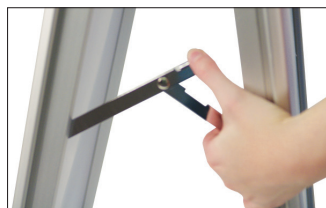

## Storage

Store in a cool dry location.

## Care

Spot clean with dry cloth for graphics.. Use glass cleaner and wipe with dry cloth for hardware metal and for acrylic inserts.