

# Claw Sail Sign

## Product Parts

- 1 - Carry Case
- 2 - Right Bottom Pole
- 3 - Left Bottom Pole
- 4 - Right Top Pole
- 5 - Left Top Pole
- 6 - Right Post
- 7 - Left Post
- 8 - Pin
- 9 - Graphic
- 10 - Bungie with Clip (x2)

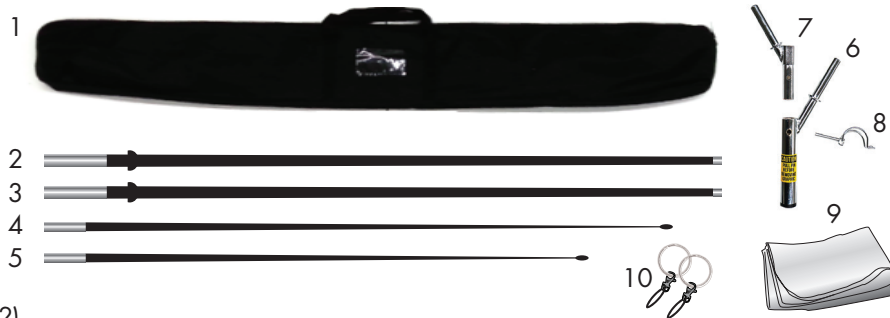

## Display Set-Up

### Step 1

Begin by removing all parts from the Carry Case (1) and place on a clean, flat surface.

### Step 2

Insert the Left Post (7) into the Right Post (6) as shown below.



### Step 3

Assemble the poles. Insert Right Bottom Pole (2) into Right Post (6) and Right Top pole (4) into Right Bottom pole (2). Insert Left Bottom pole (3) into Left Post (7) and Left Top pole (5) into Left Bottom pole (3).

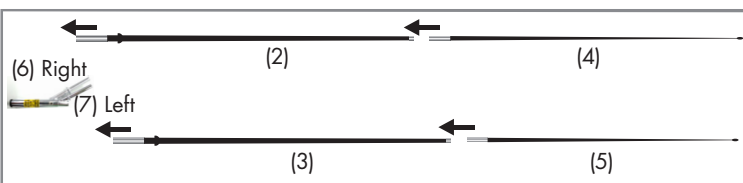

**NOTE:** Right Top Pole (4) is longer.

### Step 4

Insert assembled post and poles into a base. Base sold separately.

Slide the Graphic (9) down the poles and connect the Bungie with Clips (10) to the tabs on the post as shown in assembly.

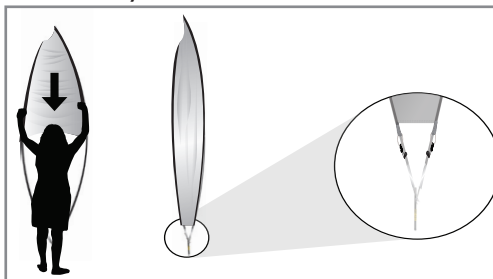

### Step 5

Spread posts (6 & 7) apart and insert pin(8).

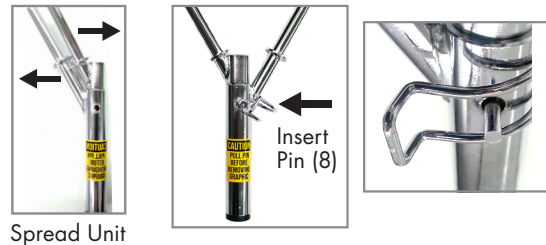

## Disassembly

To disassemble, pull Pin (8) and rotate unit closed. Remove Bungies (10) from pole. Slide Graphic (9) off the poles.

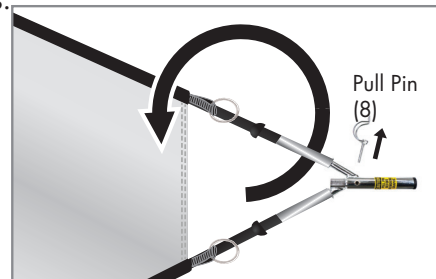

## Storage & Care

Place all product parts into Carry Case and store in a cool dry location, away from direct sunlight.

To clean, Machine wash on cold gentle cycle, air dry.

Do not iron or dry clean the Graphic.