

3', 6', 10', 20' TRIGA GO

Product Parts	3'	6'	10'	20'
1. Top Pole	x2	x3	x4	x7
2. Bottom Pole	x2	x3	x4	x7
3. Feet	x2	x3	x4	x7
4. Bottom Crossbar	x1	x2	x3	x6
5. Top Crossbar	x1	x2	x3	x6
6. Stabilizer Bar	x2	x4	x6	x12
7. Graphic	x1	x1	x1	x1

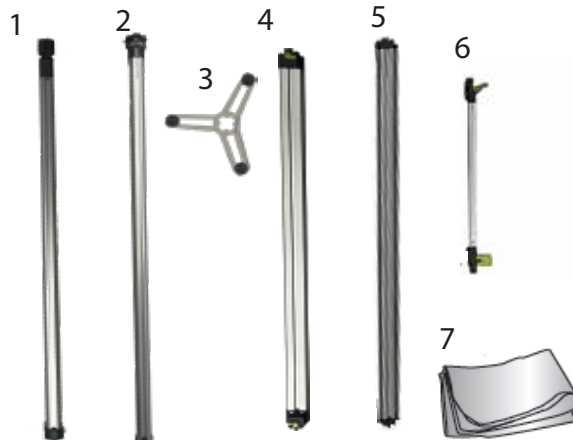

Display Set-up

Step 1

Attach the Top Pole (1) to the Bottom Pole (2) by turning connector locks.

Place Feet (3) on the floor, place the bottom pole in the slots in the foot, twisting until locked in place.

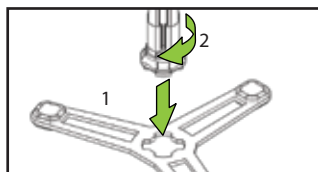
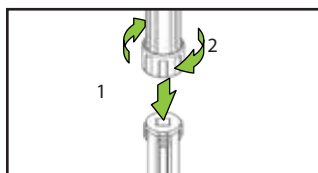

Place feet so they are pointing at one another



Step 2

Slide the Bottom Crossbar (4) into the grooves on the Bottom Pole (2).

Lock Bottom Crossbar by turning green knob to locked position.

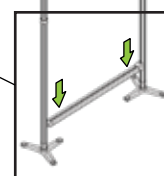
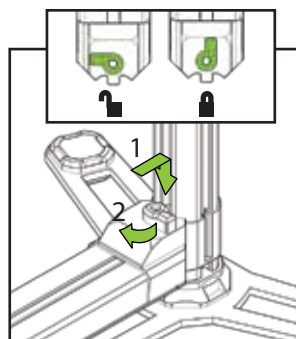

Step 3

Slide the Top Crossbar (5) into the slot on the Top Pole (1).

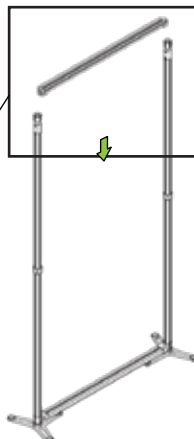
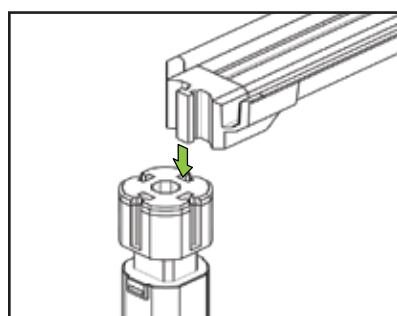

Step 4

Attach the stabilizer Bars (6) at a 45° angle by sliding notched end into groove in Bottom Pole (2), turn knob and press to lock.

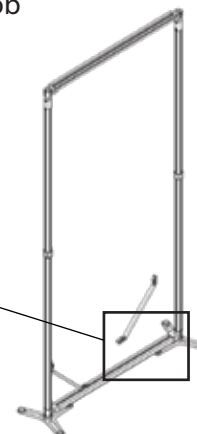
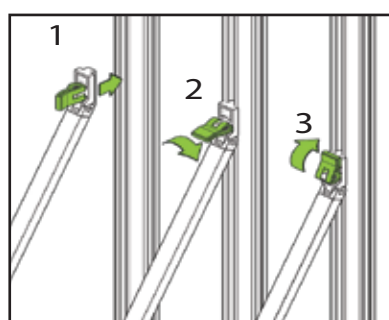

Step 5

For 6', 10', & 20' walls repeat steps 1-4 using additional parts provided until wall is complete.

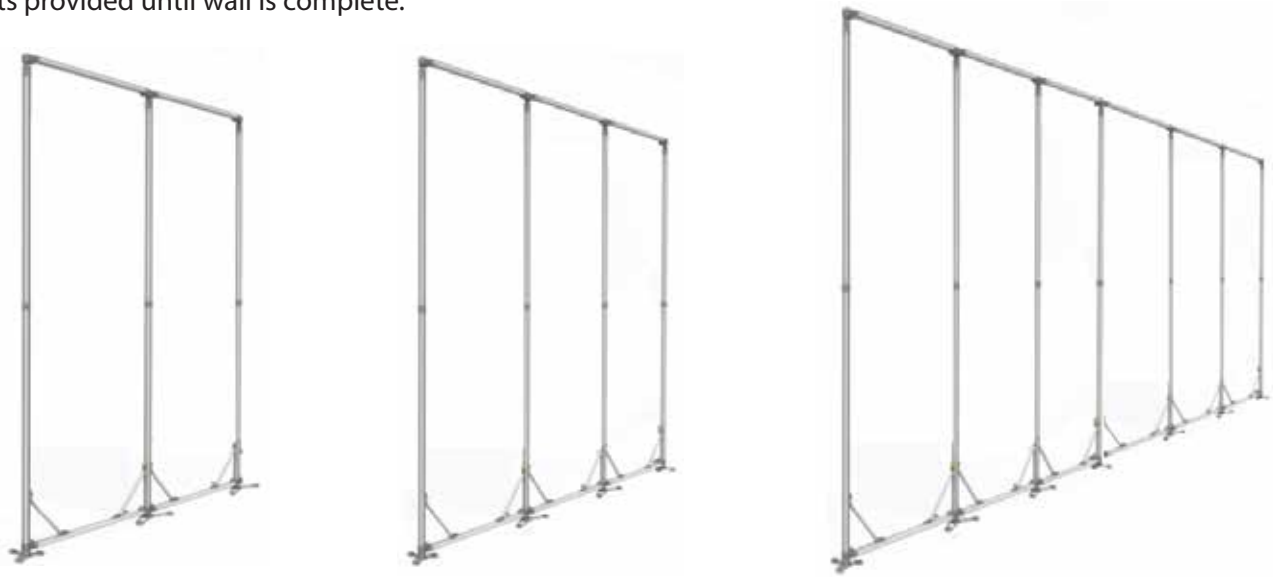

Graphic Installation

Step 1

Press down on the tension compressor at the top of each Top Pole (1) until it is in the lower position.

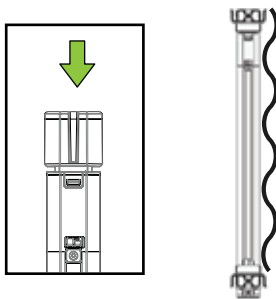

Step 2

Single Sided: Start by inserting the silicone edge into the channel in the back of the frame 6" from the side. Continue along the Top and Bottom Crossbars wrapping the graphic around the front and around from left to right, to the other side where there will be another 6" that wraps around to the back side of the display.

Double Sided: Start by inserting the silicone edge into the channel on the top cross bar at the back left side of the frame 10.5" from the edge. Continue along the top and bottom crossbars wrapping the graphic around the front from left to right. Wrap all the way back to the starting point. There will approximately 9" of graphic overlap.

Step 3

Press down once more on the tension compressor to pop it back up and graphic becomes taut.

Green switch will lock Compressor in its current position.

Not necessary to lock once graphic is installed on wall.

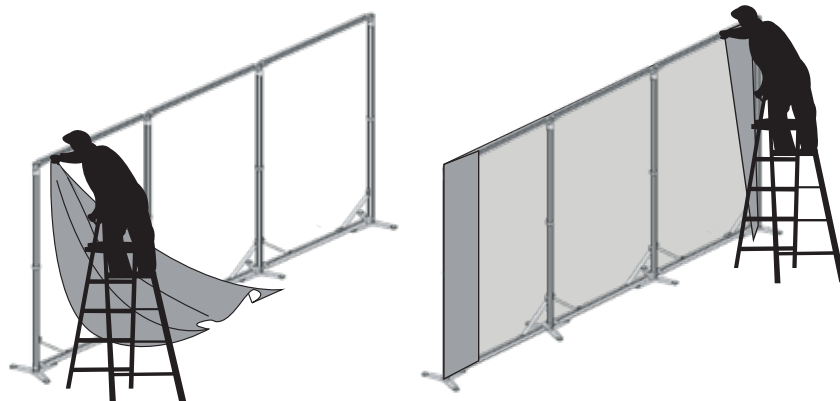
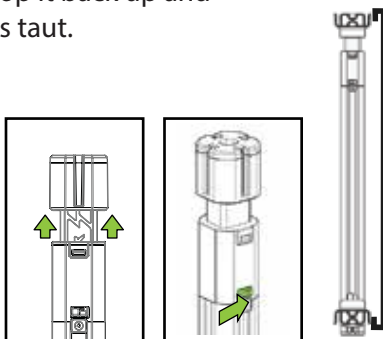

Storage & Care

Place all product parts into Carry Case and store in a cool dry location. To clean non-graphic hardware, wipe with a damp cloth.