

# TRIGA Go Shelf Kit

## Product Parts

1. Top Pole (x2)
2. Bottom Pole (x2)
3. Shelf Mounts (x4)
4. Shelf (x2)
5. Double Pole Foot (x2)
6. Double Pole Top Bracket (x2)
7. Top Bracket Thumbscrew (x2)

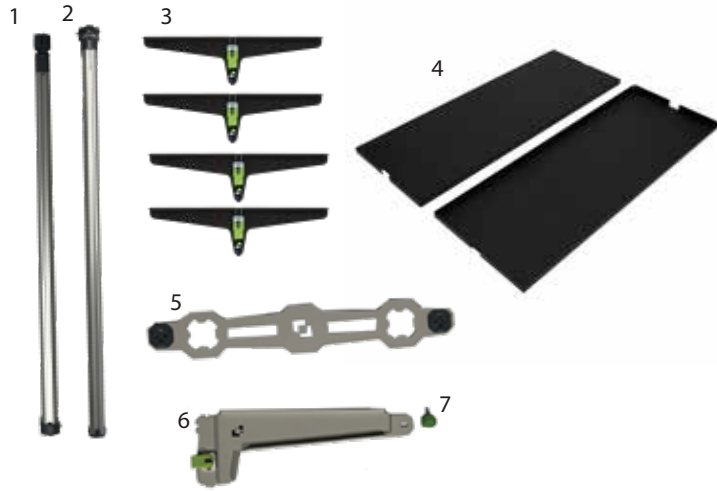

## Display Set-up

### Step 1

Attach the Top Pole (1) to the Bottom Pole (2) by turning connector locks.

Repeat for second Pole.

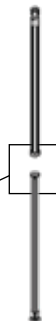
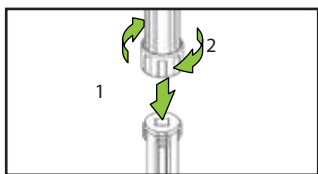

### Step 2

Replace the feet on the chosen poles from your current TRIGA Go wall or U-booth with the Double Pole Foot (5).

Insert Bottom Pole (2) into the remaining space on the Double Pole Foot. Twist pole to secure.



### Step 3

Attach the Double Pole Top Brackets (6) to the Top Crossbar on your wall or U-Booth using the turn and push knob.

Then align opening on the small end to the top of the Top Pole (1) and secure using the green Thumbscrew (7).



### Step 4

At your preferred height, install the Shelf Mounts (3) onto the Poles using the turn and push knobs, making sure that height of each mount is the same on each pole.

Place the Shelf (4) onto the Shelf Mounts (3).

Repeat for Second Shelf.



How to use turn and push knobs

1. Insert the ridge into the track on the hardware with the knob parallel to the track
2. Turn knob so it is perpendicular to Track in the Hardware
3. Push to secure

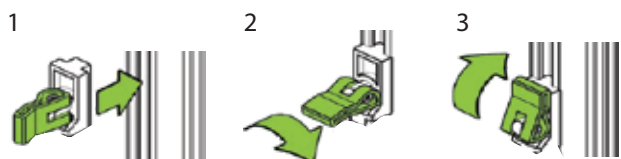

## Storage & Care

Store in a cool dry location. To clean, wipe with a damp cloth.